

- d) a charity please complete section (B)
- e) the proprietor of an educational establishment please complete section (B)
- f) a health service body please complete section (B)
- g) a person who is registered under Part 2 of the Care Standards Act 2000 (c14) in respect of an independent hospital in Wales please complete section (B)
- ga) a person who is registered under Chapter 2 of Part 1 of the Health and Social Care Act 2008 (within the meaning of that Part) in an independent hospital in England please complete section (B)
- h) the chief officer of police of a police force in England and Wales please complete section (B)

* If you are applying as a person described in (a) or (b) please confirm (by ticking yes to one box below):

I am carrying on or proposing to carry on a business which involves the use of the premises for licensable activities; or

I am making the application pursuant to a

statutory function or

a function discharged by virtue of Her Majesty's prerogative

(A) INDIVIDUAL APPLICANTS (fill in as applicable)

M r	Mrs	Miss	Ms	Other Title (for example, Rev)	
Surname			First names		
Date of birth		I am 18 years old or over		Please tick yes	
Nationality					
Current residential address if different from premises address					
Post town				Postcode	
Daytime contact telephone number					
E-mail address (optional)					
Where applicable (if demonstrating a right to work via the Home Office online right to work checking service), the 9-digit 'share code' provided to the applicant by that service (please see note 15 for information)					

Description of applicant (for example, partnership, company, unincorporated association etc.) Limited Company
Telephone number (if any)
E-mail address (optional)

Part 3 Operating Schedule

When do you want the premises licence to start?

DD	MM	YYYY
16	03	2019

If you wish the licence to be valid only for a limited period, when do you want it to end?

DD	MM	YYYY

Please give a general description of the premises (please read guidance note 1)

The site will operate as a Bar / Restaurant on the Ground Floor Level. Premises Licence facilities will be located as per the plan, and the Application will seek the provision of regulated entertainment, provision of late-night refreshment, and the supply of alcohol, each as particularised within their specific sections in the Application form.

If 5,000 or more people are expected to attend the premises at any one time, please state the number expected to attend.

--

What licensable activities do you intend to carry on from the premises?

(please see sections 1 and 14 and Schedules 1 and 2 to the Licensing Act 2003)

Provision of regulated entertainment (please read guidance note 2)

, Please tick all that apply

- a) plays (if ticking yes, fill in box A) X
- b) films (if ticking yes, fill in box B) X
- c) indoor sporting events (if ticking yes, fill in box C)
- d) boxing or wrestling entertainment (if ticking yes, fill in box D)
- e) live music (if ticking yes, fill in box E) X

--

SECOND INDIVIDUAL APPLICANT (if applicable)

M r	Mrs	Miss	Ms	Other Title (for example, Rev)	
Surname			First names		
Date of birth		I am 18 years old or over		Please tick yes	
Nationality					
Where applicable (if demonstrating a right to work via the Home Office online right to work checking service), the 9-digit 'share code' provided to the applicant by that service: (please see note 15 for information)					
Current residential address if different from premises address					
Post town				Postcode	
Daytime contact telephone number					
E-mail address (optional)					

(B) OTHER APPLICANTS

Please provide name and registered address of applicant in full. Where appropriate please give any registered number. In the case of a partnership or other joint venture (other than a body corporate), please give the name and address of each party concerned.

Name of Limited Company: Chia Chia Limited
Address 72 (b), New Court Way, Ormskirk, L39 2YT
Registered number (where applicable) 10296803

- f) recorded music (if ticking yes, fill in box F) X
- g) performances of dance (if ticking yes, fill in box G) X
- h) anything of a similar description to that falling within (e), (f) or (g)
(if ticking yes, fill in box H) X

Provision of late-night refreshment (if ticking yes, fill in box I) X

Supply of alcohol (if ticking yes, fill in box J) X

In all cases complete boxes K, L and M

A

Plays Standard days and timings (please read guidance note 7)			Will the performance of a play take place indoors or outdoors or both – please tick (please read guidance note 3)	Indoors	X
Day	Start	Finish		Outdoors	
				Both	
Mon	08.00	02.00	Please give further details here (please read guidance note 4) A facility for the provision of plays for patrons.		
Tue	08.00	02.00			
Wed	08.00	02.00	State any seasonal variations for performing plays (please read guidance note 5) See NST below.		
Thur	08.00	02.00			
Fri	08.00	02.00	Non-standard timings. Where you intend to use the premises for the performance of plays at different times to those listed in the column on the left, please list (please read guidance note 6) Permitted hours shall be extended from the normal terminal hour on New Year's Eve (into New Year's Day), and until the normal commencement hour on New Year's Day. Upon the commencement of BST, the terminal hour for Licensable Activities, and the opening hours, shall be extended by one hour.		
Sat	08.00	02.00			
Sun	08.00	02.00			

B

Films Standard days and timings (please read guidance note 7)			Will the exhibition of films take place indoors or outdoors or both – please tick (please read guidance note 3)	Indoors	X
Day	Start	Finish		Outdoors	
Mon	08.00	02.00		Please give further details here (please read guidance note 4) A facility for the provision of films for patrons.	
Tue	08.00	02.00			
Wed	08.00	02.00	State any seasonal variations for the exhibition of films (please read guidance note 5) See NST below.		
Thur	08.00	02.00			
Fri	08.00	02.00	Non-standard timings. Where you intend to use the premises for the exhibition of films at different times to those listed in the column on the left, please list (please read guidance note 6) Please apply here the exact wording as incorporated for NST within Box A above, plays.		
Sat	08.00	02.00			
Sun	08.00	02.00			

C

Indoor sporting events Standard days and timings (please read guidance note 7)			<u>Please give further details</u> (please read guidance note 4)
Day	Start	Finish	
Mon			
Tue			
Wed			<u>State any seasonal variations for indoor sporting events</u> (please read guidance note 5)
Thur			
Fri			<u>Non-standard timings. Where you intend to use the premises for indoor sporting events at different times to those listed in the column on the left, please list</u> (please read guidance note 6)
Sat			
Sun			

D

Boxing or wrestling entertainments Standard days and timings (please read guidance note 7)			<u>Will the boxing or wrestling entertainment take place indoors or outdoors or both – please tick</u> (please read guidance note 3)	Indoors	X
Day	Start	Finish		Outdoors	
Mon			<u>Please give further details here</u> (please read guidance note 4)	Both	
Tue					
Wed			<u>State any seasonal variations for boxing or wrestling entertainment</u> (please read guidance note 5)		
Thur					
Fri			<u>Non-standard timings. Where you intend to use the premises for boxing or wrestling entertainment at different times to those listed in the column on the left, please list</u> (please read guidance note 6)		
Sat					
Sun					

E

Live music Standard days and timings (please read guidance note 7)			<u>Will the performance of live music take place indoors or outdoors or both – please tick</u> (please read guidance note 3)	Indoors	X
				Outdoors	
				Both	
Day	Start	Finish			
Mon	08.00	02.00	<u>Please give further details here</u> (please read guidance note 4) A facility for the provision of live music for patrons.		
Tue	08.00	02.00			
Wed	08.00	02.00	<u>State any seasonal variations for the performance of live music</u> (please read guidance note 5) See NST below.		
Thur	08.00	02.00			
Fri	08.00	02.00	<u>Non-standard timings. Where you intend to use the premises for the performance of live music at different times to those listed in the column on the left, please list</u> (please read guidance note 6). Please apply here the exact wording as incorporated for NST within Box A above, plays.		
Sat	08.00	02.00			
Sun	08.00	02.00			

F

Recorded music Standard days and timings (please read guidance note 7)			Will the playing of recorded music take place indoors or outdoors or both – please tick (please read guidance note 3)	Indoors	X
Day	Start	Finish		Outdoors	
Mon	08.00	02.00		Please give further details here (please read guidance note 4) A facility for the provision of recorded music for patrons.	
Tue	08.00	02.00			
Wed	08.00	02.00	State any seasonal variations for the playing of recorded music (please read guidance note 5) See NST below.		
Thur	08.00	02.00			
Fri	08.00	02.00	Non-standard timings. Where you intend to use the premises for the playing of recorded music at different times to those listed in the column on the left, please list (please read guidance note 6) Please apply here the exact wording as incorporated for NST within Box A above, plays.		
Sat	08.00	02.00			
Sun	08.00	02.00			

G

Performances of dance Standard days and timings (please read guidance note 7)			<u>Will the performance of dance take place indoors or outdoors or both – please tick</u> (please read guidance note 3)	Indoors	X
Day	Start	Finish		Outdoors	
				Both	
Mon	08.00	02.00	<u>Please give further details here</u> (please read guidance note 4) A facility for the provision of dance for patrons.		
Tue	08.00	02.00			
Wed	08.00	02.00	<u>State any seasonal variations for the performance of dance</u> (please read guidance note 5) See NST below.		
Thur	08.00	02.00			
Fri	08.00	02.00	<u>Non-standard timings. Where you intend to use the premises for the performance of dance at different times to those listed in the column on the left, please list</u> (please read guidance note 6) Please apply here the exact wording as incorporated for NST within Box A above, plays.		
Sat	08.00	02.00			
Sun	08.00	02.00			

H

<p>Anything of a similar description to that falling within (e), (f) or (g) Standard days and timings (please read guidance note 7)</p>			<p>Please give a description of the type of entertainment you will be providing A facility for the provision of live music, recorded music and dancing.</p>		
Day	Start	Finish	<p><u>Will this entertainment take place indoors or outdoors or both – please tick</u> (please read guidance note 3)</p>	Indoors	X
Mon	08.00	02.00		Outdoors	
Tue	08.00	02.00		Both	
Wed	08.00	02.00	<p><u>Please give further details here</u> (please read guidance note 4) A facility for the provision of live music, recorded music and dancing for patrons.</p>		
Thur	08.00	02.00	<p><u>State any seasonal variations for entertainment of a similar description to that falling within (e), (f) or (g)</u> (please read guidance note 5) See NST below.</p>		
Fri	08.00	02.00			
Sat	08.00	02.00	<p><u>Non-standard timings. Where you intend to use the premises for the entertainment of a similar description to that falling within (e), (f) or (g) at different times to those listed in the column on the left, please list</u> (please read guidance note 6) Please apply here the exact wording as incorporated for NST within Box A above, plays.</p>		
Sun	08.00	02.00			

I

Late night refreshment Standard days and timings (please read guidance note 7)			Will the provision of late-night refreshment take place indoors or outdoors or both – please tick (please read guidance note 3)	Indoors	
Day	Start	Finish		Outdoors	
				Both	X
Mon	23.00	02.00	<u>Please give further details here</u> (please read guidance note 4) A facility for the provision of late-night refreshment for patrons.		
Tue	23.00	02.00			
Wed	23.00	02.00	<u>State any seasonal variations for the provision of late-night refreshment</u> (please read guidance note 5) See NST below.		
Thur	23.00	02.00			
Fri	23.00	02.00	<u>Non-standard timings. Where you intend to use the premises for the provision of late-night refreshment at different times, to those listed in the column on the left, please list</u> (please read guidance note 6)		
Sat	23.00	02.00	Please apply here the exact wording as incorporated for NST within Box A above, plays.		
Sun	23.00	02.00			

J

Supply of alcohol Standard days and timings (please read guidance note 7)			Will the supply of alcohol be for <u>consumption – please tick</u> (please read guidance note 8)	On the premises	
Day	Start	Finish		Off the premises	
Mon	08.00	02.00	<u>State any seasonal variations for the supply of alcohol</u> (please read guidance note 5) See NST below. <u>Non-standard timings. Where you intend to use the premises for the supply of alcohol at different times to those listed in the column on the left, please list</u> (please read guidance note 6) Please apply here the exact wording as incorporated for NST within Box A above, plays.		
Tue	08.00	02.00			
Wed	08.00	02.00			
Thur	08.00	02.00			
Fri	08.00	02.00			
Sat	08.00	02.00			
Sun	08.00	02.00			X

State the name and details of the individual whom you wish to specify on the licence as designated premises supervisor (Please see declaration about the entitlement to work in the checklist at the end of the form):

Name: Josh Gordon	
Date of birth	[REDACTED]
[REDACTED]	
Postcode	[REDACTED]
Personal licence number (if known) Application Pending.	
Issuing licensing authority (if known) [REDACTED]	

K

Please highlight any adult entertainment or services, activities, other entertainment or matters ancillary to the use of the premises that may give rise to concern in respect of children (please read guidance note 9).
None.

L

<p>Hours premises are open to the public Standard days and timings (please read guidance note 7)</p>			<p>State any seasonal variations (please read guidance note 5) See NST below.</p>
Day	Start	Finish	<p>Non-standard timings. Where you intend the premises to be open to the public at different times from those listed in the column on the left, please list (please read guidance note 6) Please apply here the exact wording as incorporated for NST within Box A above, plays.</p>
Mon	08.00	02.30	
Tue	08.00	02.30	
Wed	08.00	02.30	
Thur	08.00	02.30	
Fri	08.00	02.30	
Sat	08.00	02.30	
Sun	08.00	02.30	

M

Describe the steps you intend to take to promote the four licensing objectives:

a) General – all four licensing objectives (b, c, d and e) (please read guidance note 10)

The subject premises will apply a standard of operation which will ensure compliance with all four Licensing Objectives, based upon factors more particularly outlined within sections (b) to (e) below.

b) The prevention of crime and disorder

The style and operation of the premises is designed to minimise the potential for crime and disorder. This is achieved by the use of CCTV, along with a due-diligence system to include relevant training for staff.

c) Public safety

In addition to b above, all requirements of the Responsible Authorities will be followed, complying with all Fire Safety, and Health & Safety Regulations.

d) The prevention of public nuisance

In addition to b and c above, the premises will operate any Local Authority litter / refuse collection regulations that may apply, and the Applicant welcomes any communications from any interested party concerning the operation of the premises.

e) The protection of children from harm

In addition to b, c and d above, staff will be subject to due-diligence training to endeavour prevention of unlawful sales.

Checklist:

Please tick to indicate agreement

I have made or enclosed payment of the fee. X

I have enclosed the plan of the premises. X

I have sent copies of this application and the plan to responsible authorities and others where applicable. X

I have enclosed the consent form completed by the individual I wish to be designated premises supervisor, if applicable. X

I understand that I must now advertise my application. X

I understand that if I do not comply with the above requirements my application will be rejected. X

[Applicable to all individual applicants, including those in a partnership which is not a limited liability partnership, but not companies or limited liability partnerships] I have included documents demonstrating my entitlement to work in the United Kingdom or my share code issued by the Home Office online right to work checking service (please read note 15).

IT IS AN OFFENCE, UNDER SECTION 158 OF THE LICENSING ACT 2003, TO MAKE A FALSE STATEMENT IN OR IN CONNECTION WITH THIS APPLICATION. THOSE WHO MAKE A FALSE STATEMENT MAY BE LIABLE ON SUMMARY CONVICTION TO A FINE OF ANY AMOUNT.

IT IS AN OFFENCE UNDER SECTION 24B OF THE IMMIGRATION ACT 1971 FOR A PERSON TO WORK WHEN THEY KNOW, OR HAVE REASONABLE CAUSE TO BELIEVE, THAT THEY ARE DISQUALIFIED FROM DOING SO BY REASON OF THEIR IMMIGRATION STATUS. THOSE WHO EMPLOY AN ADULT WITHOUT LEAVE OR WHO IS SUBJECT TO CONDITIONS AS TO EMPLOYMENT WILL BE LIABLE TO A CIVIL PENALTY UNDER SECTION 15 OF THE IMMIGRATION, ASYLUM AND NATIONALITY ACT 2006 AND PURSUANT TO SECTION 21 OF THE SAME ACT, WILL BE COMMITTING AN OFFENCE WHERE THEY DO SO IN THE KNOWLEDGE, OR WITH REASONABLE CAUSE TO BELIEVE, THAT THE EMPLOYEE IS DISQUALIFIED.

Part 4 – Signatures (please read guidance note 11)

Signature of applicant or applicant's solicitor or other duly authorised agent (see guidance note 12). **If signing on behalf of the applicant, please state in what capacity.**

Declaration	<ul style="list-style-type: none">• [Applicable to individual applicants only, including those in a partnership which is not a limited liability partnership] I understand I am not entitled to be issued with a licence if I do not have the entitlement to live and work in the UK (or if I am subject to a condition preventing me from doing work relating to the carrying on of a licensable activity) and that my licence will become invalid if I cease to be entitled to live and work in the UK (please read guidance note 15).• The DPS named in this application form is entitled to work in the UK (and is not subject to conditions preventing him or her from doing work relating to a licensable activity) and I have seen a copy of his or
--------------------	---

	her proof of entitlement to work, or have conducted an online right to work check using the Home Office online right to work checking service which confirmed their right to work (please see note 15)
Signature	VC Law Limited. 
Date	15 TH February 2019
Capacity	Solicitors instructed for and on behalf of the Applicant.

For joint applications, signature of 2nd applicant or 2nd applicant's solicitor or other authorised agent (please read guidance note 13). If signing on behalf of the applicant, please state in what capacity.

Signature	
Date	
Capacity	

Contact name (where not previously given) and postal address for correspondence associated with this application (please read guidance note 14) VC Law Limited, Units 3 /4, The Brewery Works, Stanhope Street,			
Post town	Liverpool	Postcode	L8 5XJ
Telephone number (if any)	07853 681999		
If you would prefer us to correspond with you by e-mail, your e-mail address (optional) carl.bruder@vclaw.co.uk			

Notes for Guidance

1. Describe the premises, for example the type of premises, its general situation and layout and any other information which could be relevant to the licensing objectives. Where your application includes off-supplies of alcohol and you intend to provide a place for consumption of these off-supplies, you must include a description of where the place will be and its proximity to the premises.
2. In terms of specific regulated entertainments please note that:
 - Plays: no licence is required for performances between 08:00 and 23:00 on any day, provided that the audience does not exceed 500.
 - Films: no licence is required for 'not-for-profit' film exhibition held in community premises between 08:00 and 23:00 on any day provided that the audience does not exceed 500 and the organiser (a) gets consent to the screening from a person who is responsible for the premises; and (b) ensures that each such screening abides by age classification ratings.
 - Indoor sporting events: no licence is required for performances between 08:00 and 23:00 on any day, provided that the audience does not exceed 1000.
 - Boxing or Wrestling Entertainment: no licence is required for a contest, exhibition or display of Greco-Roman wrestling, or freestyle wrestling between 08:00 and 23:00 on any day, provided that the audience does not exceed 1000. Combined fighting sports – defined as a contest, exhibition or display which combines boxing or wrestling with one or more martial arts – are licensable as a boxing or wrestling entertainment rather than an indoor sporting event.
 - Live music: no licence permission is required for:
 - a performance of unamplified live music between 08:00 and 23:00 on any day, on any premises.
 - a performance of amplified live music between 08:00 and 23:00 on any day on premises authorised to sell alcohol for consumption on those premises, provided that the audience does not exceed 500.
 - a performance of amplified live music between 08:00 and 23:00 on any day, in a workplace that is not licensed to sell alcohol on those premises, provided that the audience does not exceed 500.
 - a performance of amplified live music between 08:00 and 23:00 on any day, in a church hall, village hall, community hall, or other similar community premises, that is not licensed by a premises licence to sell alcohol, provided that (a) the audience does not exceed 500, and (b) the organiser gets consent for the performance from a person who is responsible for the premises.
 - a performance of amplified live music between 08:00 and 23:00 on any day, at the non-residential premises of (i) a local authority, or (ii) a school, or (iii) a hospital, provided that (a) the audience does not exceed 500, and (b) the organiser gets consent for the performance on the relevant premises from: (i) the local authority concerned, or (ii) the school or (iii) the health care provider for the hospital.
 - Recorded Music: no licence permission is required for:
 - any playing of recorded music between 08:00 and 23:00 on any day on premises authorised to sell alcohol for consumption on those premises, provided that the audience does not exceed 500.
 - any playing of recorded music between 08:00 and 23:00 on any day, in a church hall, village hall, community hall, or other similar community premises, that is not licensed by a premises licence to sell alcohol, provided that (a) the audience does not exceed 500, and (b) the organiser gets consent for the performance from a person who is responsible for the premises.
 - any playing of recorded music between 08:00 and 23:00 on any day, at the non-residential premises of (i) a local authority, or (ii) a school, or (iii) a hospital, provided that (a) the audience does not exceed 500, and

M&S Car Park

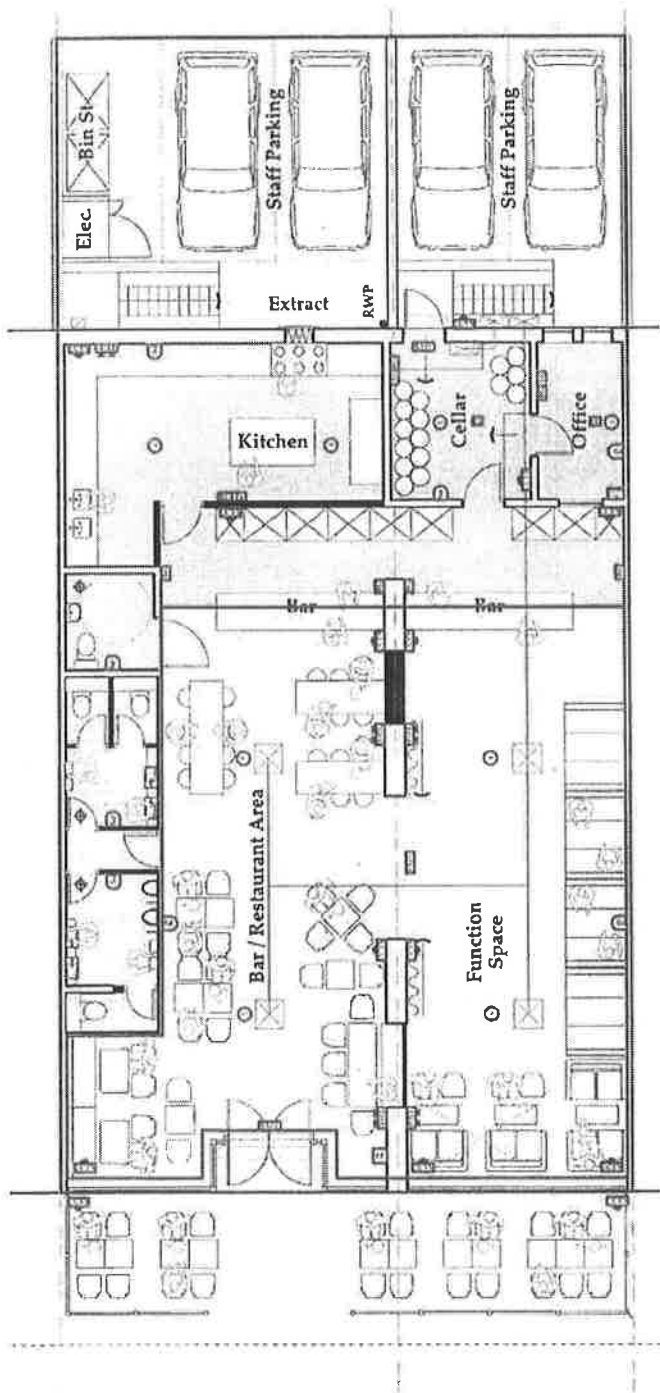

Aughton Street



368 CHIA CHIA
 ARCHITECTURAL INFORMATION
 13/14B - 14/15B - 14/16 - 14/17 - 14/18 - 14/19 - 14/20 - 14/21 - 14/22 - 14/23 - 14/24 - 14/25 - 14/26 - 14/27 - 14/28 - 14/29 - 14/30 - 14/31 - 14/32 - 14/33 - 14/34 - 14/35 - 14/36 - 14/37 - 14/38 - 14/39 - 14/40 - 14/41 - 14/42 - 14/43 - 14/44 - 14/45 - 14/46 - 14/47 - 14/48 - 14/49 - 14/50 - 14/51 - 14/52 - 14/53 - 14/54 - 14/55 - 14/56 - 14/57 - 14/58 - 14/59 - 14/60 - 14/61 - 14/62 - 14/63 - 14/64 - 14/65 - 14/66 - 14/67 - 14/68 - 14/69 - 14/70 - 14/71 - 14/72 - 14/73 - 14/74 - 14/75 - 14/76 - 14/77 - 14/78 - 14/79 - 14/80 - 14/81 - 14/82 - 14/83 - 14/84 - 14/85 - 14/86 - 14/87 - 14/88 - 14/89 - 14/90 - 14/91 - 14/92 - 14/93 - 14/94 - 14/95 - 14/96 - 14/97 - 14/98 - 14/99 - 14/100 - 14/101 - 14/102 - 14/103 - 14/104 - 14/105 - 14/106 - 14/107 - 14/108 - 14/109 - 14/110 - 14/111 - 14/112 - 14/113 - 14/114 - 14/115 - 14/116 - 14/117 - 14/118 - 14/119 - 14/120 - 14/121 - 14/122 - 14/123 - 14/124 - 14/125 - 14/126 - 14/127 - 14/128 - 14/129 - 14/130 - 14/131 - 14/132 - 14/133 - 14/134 - 14/135 - 14/136 - 14/137 - 14/138 - 14/139 - 14/140 - 14/141 - 14/142 - 14/143 - 14/144 - 14/145 - 14/146 - 14/147 - 14/148 - 14/149 - 14/150 - 14/151 - 14/152 - 14/153 - 14/154 - 14/155 - 14/156 - 14/157 - 14/158 - 14/159 - 14/160 - 14/161 - 14/162 - 14/163 - 14/164 - 14/165 - 14/166 - 14/167 - 14/168 - 14/169 - 14/170 - 14/171 - 14/172 - 14/173 - 14/174 - 14/175 - 14/176 - 14/177 - 14/178 - 14/179 - 14/180 - 14/181 - 14/182 - 14/183 - 14/184 - 14/185 - 14/186 - 14/187 - 14/188 - 14/189 - 14/190 - 14/191 - 14/192 - 14/193 - 14/194 - 14/195 - 14/196 - 14/197 - 14/198 - 14/199 - 14/200 - 14/201 - 14/202 - 14/203 - 14/204 - 14/205 - 14/206 - 14/207 - 14/208 - 14/209 - 14/210 - 14/211 - 14/212 - 14/213 - 14/214 - 14/215 - 14/216 - 14/217 - 14/218 - 14/219 - 14/220 - 14/221 - 14/222 - 14/223 - 14/224 - 14/225 - 14/226 - 14/227 - 14/228 - 14/229 - 14/230 - 14/231 - 14/232 - 14/233 - 14/234 - 14/235 - 14/236 - 14/237 - 14/238 - 14/239 - 14/240 - 14/241 - 14/242 - 14/243 - 14/244 - 14/245 - 14/246 - 14/247 - 14/248 - 14/249 - 14/250 - 14/251 - 14/252 - 14/253 - 14/254 - 14/255 - 14/256 - 14/257 - 14/258 - 14/259 - 14/260 - 14/261 - 14/262 - 14/263 - 14/264 - 14/265 - 14/266 - 14/267 - 14/268 - 14/269 - 14/270 - 14/271 - 14/272 - 14/273 - 14/274 - 14/275 - 14/276 - 14/277 - 14/278 - 14/279 - 14/280 - 14/281 - 14/282 - 14/283 - 14/284 - 14/285 - 14/286 - 14/287 - 14/288 - 14/289 - 14/290 - 14/291 - 14/292 - 14/293 - 14/294 - 14/295 - 14/296 - 14/297 - 14/298 - 14/299 - 14/300 - 14/301 - 14/302 - 14/303 - 14/304 - 14/305 - 14/306 - 14/307 - 14/308 - 14/309 - 14/310 - 14/311 - 14/312 - 14/313 - 14/314 - 14/315 - 14/316 - 14/317 - 14/318 - 14/319 - 14/320 - 14/321 - 14/322 - 14/323 - 14/324 - 14/325 - 14/326 - 14/327 - 14/328 - 14/329 - 14/330 - 14/331 - 14/332 - 14/333 - 14/334 - 14/335 - 14/336 - 14/337 - 14/338 - 14/339 - 14/340 - 14/341 - 14/342 - 14/343 - 14/344 - 14/345 - 14/346 - 14/347 - 14/348 - 14/349 - 14/350 - 14/351 - 14/352 - 14/353 - 14/354 - 14/355 - 14/356 - 14/357 - 14/358 - 14/359 - 14/360 - 14/361 - 14/362 - 14/363 - 14/364 - 14/365 - 14/366 - 14/367 - 14/368 - 14/369 - 14/370 - 14/371 - 14/372 - 14/373 - 14/374 - 14/375 - 14/376 - 14/377 - 14/378 - 14/379 - 14/380 - 14/381 - 14/382 - 14/383 - 14/384 - 14/385 - 14/386 - 14/387 - 14/388 - 14/389 - 14/390 - 14/391 - 14/392 - 14/393 - 14/394 - 14/395 - 14/396 - 14/397 - 14/398 - 14/399 - 14/400 - 14/401 - 14/402 - 14/403 - 14/404 - 14/405 - 14/406 - 14/407 - 14/408 - 14/409 - 14/410 - 14/411 - 14/412 - 14/413 - 14/414 - 14/415 - 14/416 - 14/417 - 14/418 - 14/419 - 14/420 - 14/421 - 14/422 - 14/423 - 14/424 - 14/425 - 14/426 - 14/427 - 14/428 - 14/429 - 14/430 - 14/431 - 14/432 - 14/433 - 14/434 - 14/435 - 14/436 - 14/437 - 14/438 - 14/439 - 14/440 - 14/441 - 14/442 - 14/443 - 14/444 - 14/445 - 14/446 - 14/447 - 14/448 - 14/449 - 14/450 - 14/451 - 14/452 - 14/453 - 14/454 - 14/455 - 14/456 - 14/457 - 14/458 - 14/459 - 14/460 - 14/461 - 14/462 - 14/463 - 14/464 - 14/465 - 14/466 - 14/467 - 14/468 - 14/469 - 14/470 - 14/471 - 14/472 - 14/473 - 14/474 - 14/475 - 14/476 - 14/477 - 14/478 - 14/479 - 14/480 - 14/481 - 14/482 - 14/483 - 14/484 - 14/485 - 14/486 - 14/487 - 14/488 - 14/489 - 14/490 - 14/491 - 14/492 - 14/493 - 14/494 - 14/495 - 14/496 - 14/497 - 14/498 - 14/499 - 14/500 - 14/501 - 14/502 - 14/503 - 14/504 - 14/505 - 14/506 - 14/507 - 14/508 - 14/509 - 14/510 - 14/511 - 14/512 - 14/513 - 14/514 - 14/515 - 14/516 - 14/517 - 14/518 - 14/519 - 14/520 - 14/521 - 14/522 - 14/523 - 14/524 - 14/525 - 14/526 - 14/527 - 14/528 - 14/529 - 14/530 - 14/531 - 14/532 - 14/533 - 14/534 - 14/535 - 14/536 - 14/537 - 14/538 - 14/539 - 14/540 - 14/541 - 14/542 - 14/543 - 14/544 - 14/545 - 14/546 - 14/547 - 14/548 - 14/549 - 14/550 - 14/551 - 14/552 - 14/553 - 14/554 - 14/555 - 14/556 - 14/557 - 14/558 - 14/559 - 14/560 - 14/561 - 14/562 - 14/563 - 14/564 - 14/565 - 14/566 - 14/567 - 14/568 - 14/569 - 14/570 - 14/571 - 14/572 - 14/573 - 14/574 - 14/575 - 14/576 - 14/577 - 14/578 - 14/579 - 14/580 - 14/581 - 14/582 - 14/583 - 14/584 - 14/585 - 14/586 - 14/587 - 14/588 - 14/589 - 14/590 - 14/591 - 14/592 - 14/593 - 14/594 - 14/595 - 14/596 - 14/597 - 14/598 - 14/599 - 14/600 - 14/601 - 14/602 - 14/603 - 14/604 - 14/605 - 14/606 - 14/607 - 14/608 - 14/609 - 14/610 - 14/611 - 14/612 - 14/613 - 14/614 - 14/615 - 14/616 - 14/617 - 14/618 - 14/619 - 14/620 - 14/621 - 14/622 - 14/623 - 14/624 - 14/625 - 14/626 - 14/627 - 14/628 - 14/629 - 14/630 - 14/631 - 14/632 - 14/633 - 14/634 - 14/635 - 14/636 - 14/637 - 14/638 - 14/639 - 14/640 - 14/641 - 14/642 - 14/643 - 14/644 - 14/645 - 14/646 - 14/647 - 14/648 - 14/649 - 14/650 - 14/651 - 14/652 - 14/653 - 14/654 - 14/655 - 14/656 - 14/657 - 14/658 - 14/659 - 14/660 - 14/661 - 14/662 - 14/663 - 14/664 - 14/665 - 14/666 - 14/667 - 14/668 - 14/669 - 14/670 - 14/671 - 14/672 - 14/673 - 14/674 - 14/675 - 14/676 - 14/677 - 14/678 - 14/679 - 14/680 - 14/681 - 14/682 - 14/683 - 14/684 - 14/685 - 14/686 - 14/687 - 14/688 - 14/689 - 14/690 - 14/691 - 14/692 - 14/693 - 14/694 - 14/695 - 14/696 - 14/697 - 14/698 - 14/699 - 14/700 - 14/701 - 14/702 - 14/703 - 14/704 - 14/705 - 14/706 - 14/707 - 14/708 - 14/709 - 14/710 - 14/711 - 14/712 - 14/713 - 14/714 - 14/715 - 14/716 - 14/717 - 14/718 - 14/719 - 14/720 - 14/721 - 14/722 - 14/723 - 14/724 - 14/725 - 14/726 - 14/727 - 14/728 - 14/729 - 14/730 - 14/731 - 14/732 - 14/733 - 14/734 - 14/735 - 14/736 - 14/737 - 14/738 - 14/739 - 14/740 - 14/741 - 14/742 - 14/743 - 14/744 - 14/745 - 14/746 - 14/747 - 14/748 - 14/749 - 14/750 - 14/751 - 14/752 - 14/753 - 14/754 - 14/755 - 14/756 - 14/757 - 14/758 - 14/759 - 14/760 - 14/761 - 14/762 - 14/763 - 14/764 - 14/765 - 14/766 - 14/767 - 14/768 - 14/769 - 14/770 - 14/771 - 14/772 - 14/773 - 14/774 - 14/775 - 14/776 - 14/777 - 14/778 - 14/779 - 14/780 - 14/781 - 14/782 - 14/783 - 14/784 - 14/785 - 14/786 - 14/787 - 14/788 - 14/789 - 14/790 - 14/791 - 14/792 - 14/793 - 14/794 - 14/795 - 14/796 - 14/797 - 14/798 - 14/799 - 14/800 - 14/801 - 14/802 - 14/803 - 14/804 - 14/805 - 14/806 - 14/807 - 14/808 - 14/809 - 14/810 - 14/811 - 14/812 - 14/813 - 14/814 - 14/815 - 14/816 - 14/817 - 14/818 - 14/819 - 14/820 - 14/821 - 14/822 - 14/823 - 14/824 - 14/825 - 14/826 - 14/827 - 14/828 - 14/829 - 14/830 - 14/831 - 14/832 - 14/833 - 14/834 - 14/835 - 14/836 - 14/837 - 14/838 - 14/839 - 14/840 - 14/841 - 14/842 - 14/843 - 14/844 - 14/845 - 14/846 - 14/847 - 14/848 - 14/849 - 14/850 - 14/851 - 14/852 - 14/853 - 14/854 - 14/855 - 14/856 - 14/857 - 14/858 - 14/859 - 14/860 - 14/861 - 14/862 - 14/863 - 14/864 - 14/865 - 14/866 - 14/867 - 14/868 - 14/869 - 14/870 - 14/871 - 14/872 - 14/873 - 14/874 - 14/875 - 14/876 - 14/877 - 14/878 - 14/879 - 14/880 - 14/881 - 14/882 - 14/883 - 14/884 - 14/885 - 14/886 - 14/887 - 14/888 - 14/889 - 14/890 - 14/891 - 14/892 - 14/893 - 14/894 - 14/895 - 14/896 - 14/897 - 14/898 - 14/899 - 14/900 - 14/901 - 14/902 - 14/903 - 14/904 - 14/905 - 14/906 - 14/907 - 14/908 - 14/909 - 14/910 - 14/911 - 14/912 - 14/913 - 14/914 - 14/915 - 14/916 - 14/917 - 14/918 - 14/919 - 14/920 - 14/921 - 14/922 - 14/923 - 14/924 - 14/925 - 14/926 - 14/927 - 14/928 - 14/929 - 14/930 - 14/931 - 14/932 - 14/933 - 14/934 - 14/935 - 14/936 - 14/937 - 14/938 - 14/939 - 14/940 - 14/941 - 14/942 - 14/943 - 14/944 - 14/945 - 14/946 - 14/947 - 14/948 - 14/949 - 14/950 - 14/951 - 14/952 - 14/953 - 14/954 - 14/955 - 14/956 - 14/957 - 14/958 - 14/959 - 14/960 - 14/961 - 14/962 - 14/963 - 14/964 - 14/965 - 14/966 - 14/967 - 14/968 - 14/969 - 14/970 - 14/971 - 14/972 - 14/973 - 14/974 - 14/975 - 14/976 - 14/977 - 14/978 - 14/979 - 14/980 - 14/981 - 14/982 - 14/983 - 14/984 - 14/985 - 14/986 - 14/987 - 14/988 - 14/989 - 14/990 - 14/991 - 14/992 - 14/993 - 14/994 - 14/995 - 14/996 - 14/997 - 14/998 - 14/999 - 1500



- North Point

Key:

Area to be Used for Licensable Activities -

Perimeter of the Premises -

Illuminated Exit Sign -



Break Glass Fire Alarm Activation Point -



Fire Extinguisher -



Floodlight Emergency Light Fitting -



Emergency Light Fitting -



Fire Alarm Control Panel -



Smoke Sensor linked to Fire Alarm -



Heat Sensor Linked to Fire Alarm -



CCTV Control Monitor Centre -



Fire Alarm Sounder -



CCTV Camera (Dome) -



Notes:

1. A written fire risk assessment is to be carried out by the operator prior to opening.
2. Fire procedure notices are to be provided and sited adjacent fire alarm call points.
3. All fire alarm, emergency lighting, fire fighting equipment and signage to conform to the relevant British Standards.
4. All fire exit doors to be readily operable without requiring the use of a key.

Rev A: 13/02/19

Redline updated

FOR APPROVAL

CHECKED BY: AJ DRAWN BY: MS

SCALE: 1:100

PAPER SIZE: A3

JOB: 368 CHIA CHIA

4.101 Rev A

FIRST ISSUE: 31.01.19

PROPOSED LICENCE PLAN

As an alternative to providing a copy of the documents listed above, applicants may demonstrate their right to work by allowing the licensing authority to carry out a check with the Home Office online right to work checking service.

To demonstrate their right to work via the Home Office online right to work checking service, applicants should include in this application their 9-digit share code (provided to them upon accessing the service at <https://www.gov.uk/prove-right-to-work>) which, along with the applicant's date of birth (provided within this application), will allow the licensing authority to carry out the check.

In order to establish the applicant's right to work, the check will need to indicate that the applicant is allowed to work in the United Kingdom and is not subject to a condition preventing them from doing work relating to the carrying on of a licensable activity.

An online check will not be possible in all circumstances because not all applicants will have an immigration status that can be checked online. The Home Office online right to work checking service sets out what information and/or documentation applicants will need in order to access the service. Applicants who are unable to obtain a share code from the service should submit copy documents as set out above.